

G. Graffitti D & A. Graffitti Dna@gmail.com



Registered Office
GMP Technical Solutions Private Limited
309-316, 3rd floor, Swastik Disha Business Park,
Behind Wadhani Industrial Estate, L.B.S. Marg, Ghatkopar (W),
Mumbai - 400 086, Maharashtra, India.
Tel: 91 22 66083700 Fax: 91 22 66083737
E-mail: enquiry@gmptech.net
Website: www.gmptech.net, www.gmpartitions.com

Works
Gunai Road, Mandhala, Via Barotiwala,
Dist. Solan, Himachal Pradesh- 174 103, India.
Tel: 91 1792 253105, (91) 9218466806/08
Fax: 91 1792 255227
E-mail: sales@gmptech.net

Noida Office
RS- 1/3, Second floor, Savitri Market,
Sector 18, Noida (U.P.) 201301
Tel: 91 120 4204770, Fax: 91 120 4204771
E-mail: salesdelhi@gmptech.net

Goa Office
Plot No.L73, Verna Ind. Estate
Verna Salcette
Goa - 403722

Hyderabad Office
Flat no D, 1st Floor Patel Trade World
5-4-187/3&4/10/SF10, Karbala Maidan
M.G.Road, Secunderabad - 500003

METAL DOORSETS





Company Profile

GMP technical Solutions (GMP) is an ISO 9001:2008, ISO 14001:2004 and OHSAS 18001:2007 Certified Company and is one of the largest manufactures of Clean Room Partitioning Systems and Turnkey Solution Provider within the Indian subcontinent. Established in year 2005, Under the Indian Companies Act. GMP Technical Solutions has an 80,000 sq. ft. manufacturing area with an overall supportive infrastructure area of 2,50,000 sq. ft. which is fully equipped the latest NC/ CNC manufacturing equipment.

The Strategic location of the facility at the foothills of Himachal Pradesh offers ZERO Excise duty. This benefits our clients and enables GMP to offer a competitive pricing structure. All GMP products are manufactured under one roof and subsequently all metal forming, finishes, roll forming and assembly are completed in-house. As a result, specific requirement of our clients can be incorporated into a proposed design/product requirement.

GMP has its corporate office at Mumbai & Branch office in major Indian cities like Noida, Goa, Bangalore, Indore, Hyderabad and state-of-the-art manufacturing facility at Barotiwala in Himachal Pradesh, INDIA. A team of over 700 professionals support Indian & International operations of our esteemed clients in the field of Clean Room Technology, Building Management Systems, IBMS, IT & Networking, HVAC and Electricals. We provide cost effective Enterprise Solutions & Turnkey services tailored to specific projects and typical requirements. GMP's strong customer-focused approach and the continuous quest for world-class quality have enabled us to attain and sustain Clean Room Technology lead in Indian subcontinent.

Our thrust on international business has seen overseas earning grow significantly. The company's businesses are supported by a wide marketing and distribution network, and have established a reputation for strong customer support.

At GMP, we believe that progress must be achieved in harmony with the environment. A commitment to environmental protection is an integral part of the corporate vision.

Fire Door Specifications

Test Standards

2Hrs. Fire Rated Metal Doors all tested to BS 476 Part 22 Only IS:3614 Approved by CBRI (Roorkee), also approved by Warrington Fire (UK) & UL(USA) 10B & 10C dependant on construction.

Door Leaf

44 mm thick Shutter sheet thickness is 1.0 mm infill material is Rock Wool (40 kg/cu.m)

Door Frame

100x50 mm Frame size, Sheet Thickness is 1.5 mm

Infill

Rockwool of density (40-45kg/cu.m)

Finish

Doors is Pure Polyester Powder Coated 60-80 Micron

Ironmongery

All Complete Ironmongery is from DORMA or any other Compatible Make fire Door Including provision of Standard of Vision panel of 6 mm thick Fire Rated Glass. (PilkingtonUK, Pyran-Germany) with Double Skin Shutter of 44 mm thick. (GI sheet on both sides), and also including provision of fixing Panic Bar, SS D-Type OR Lever Handle with Lock, SS Push Plate, SS Flush Bolt, SS Ball Baring Hinges, Door Closer & Anchor with Cap etc.

Our Esteemed Clientele



Fire Door Certifications



GMP METAL DOORSETS

Doorsets are specifically tailored to the requirements of the market with special attention being paid to the use of galvanised steel throughout.

GMP Metal Doorsets are available in different configurations to achieve the Clients requirements. In addition to single leaf and double leaf frames, with removable overpanels, borrowed light and glazing can be introduced.

GMP COMMERCIAL DOOR

High duty general purpose metal doorsets are available in size up to 3000mm wide double doorsets and 3000 mm high.

Capable of accepting glazing in many configurations with air vents, louvers and a wide range of hardware. Finish coated in primer or epoxy polyester powder paint as standard.

GMP FIRE DOOR

Available in fire resistant levels from 30 minutes up to 6 hours all tested to BS 476 Part 22. These doorsets can be made in very large sizes with options on glazing, fire resistant self closing louvers single or double doorsets and with optional fixed overpanels. optional temperature rise (insulation) configurations.

GMP SECURE DOOR

Special attention to construction details and the addition of security hinges, multi point locks **reinforced laminated cores** and high security glazing produces a range of Secure doorsets that are suitable for high security applications. The level of protection required will determine the degree of sophistication of construction.

GMP ACOUSTIC DOOR

By the introduction of special linings, seals and structurally bonded cores a high level of sound reduction can be achieved. Consult the design office for further information.

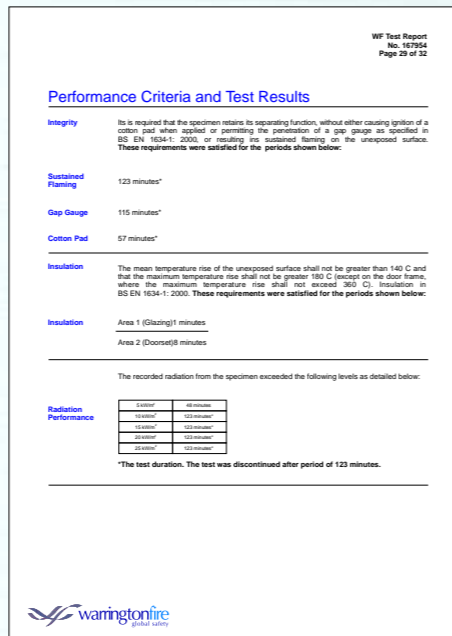
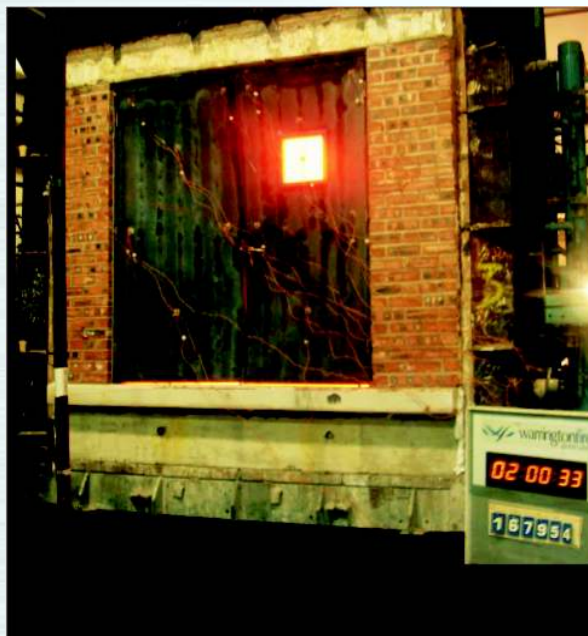

Ironmongery

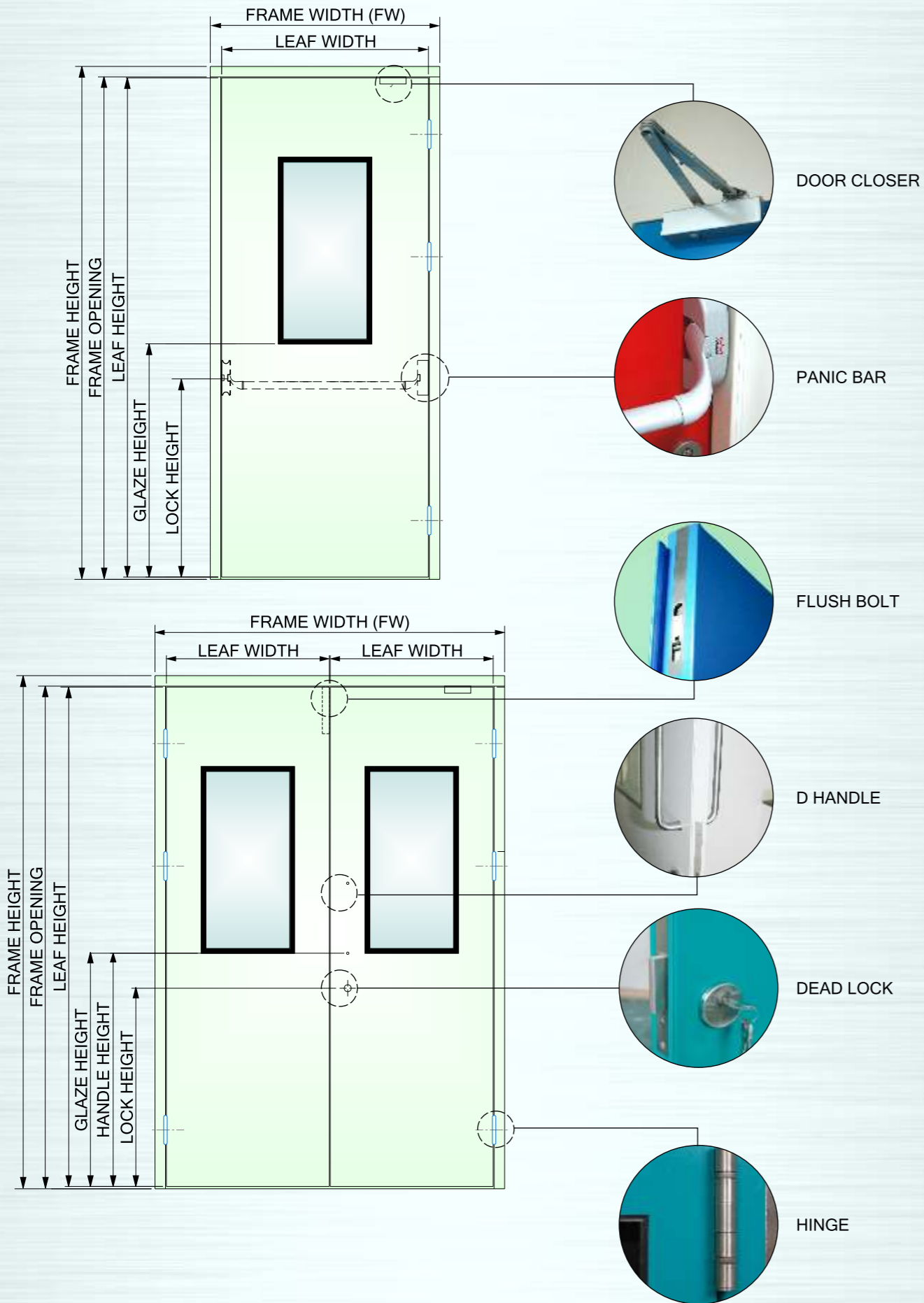

GMP Metal Doorsets and Frames

- Description** : GMP Metal Doorsets and Frames
- Construction** : Door leaf from 0.8mm/ 1.0mm/ 1.2mm / 1.6mm thick slip coated pre galvanised steel to ASTM A527/ ASTM A525, JIS G 3302 or BS 2989 (1994). Zinc coating 80-120 g.m2. Lock formed panels with internal stiffeners, 4.0mm thick hinge reinforcing, hardware mounting plates and lock protection.

Doorframe from 1.2mm/ 1.6mm/ 2.0mm thick pre galvanised steel sheet with mitered and welded corners, frame stretchers, hinge reinforcing plates, fixing plates and hardware mounting plates.
- Insulation** : Door leaf filled with either Mineral wool, Honeycomb Paper/Aluminium core Polyurethane foam.
- Finish** : Epoxy polyester powder coating.
- Fixing** : Fixing through frame by expansion bolt & Mortar straps.
- Frame Assembly** : Welded construction with frame spreaders.
Bolted frame construction.
Knock Down frame construction for wrap around frames.
- Glazing** : 5.0mm thick Glass on both side in door leaf.
- Louver** : Louvre panels to door leaves
- Fire Resistant** : Up to 2 hours fire resistance in accordance with BS 476 Part 22 dependant on construction.
- Acoustic Properties** : Up to RW 44 for 60m thick door leaves with special frames and Ancillary seals.
- Sizes** : Up to 3 mtrs high and 3 mtrs wide subject to test data limitations.

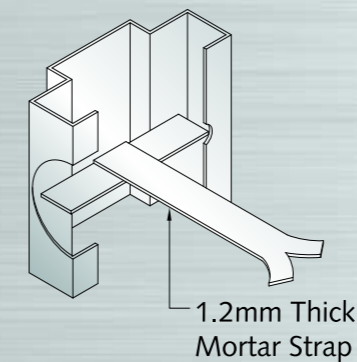

MORTAR STRAP

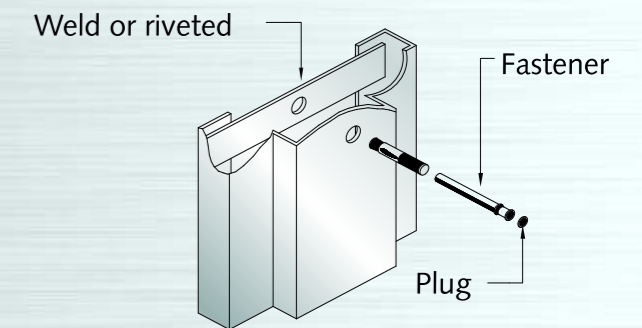

BOLT FIXING

DOOR FIXING

GMP Metal Doorsets

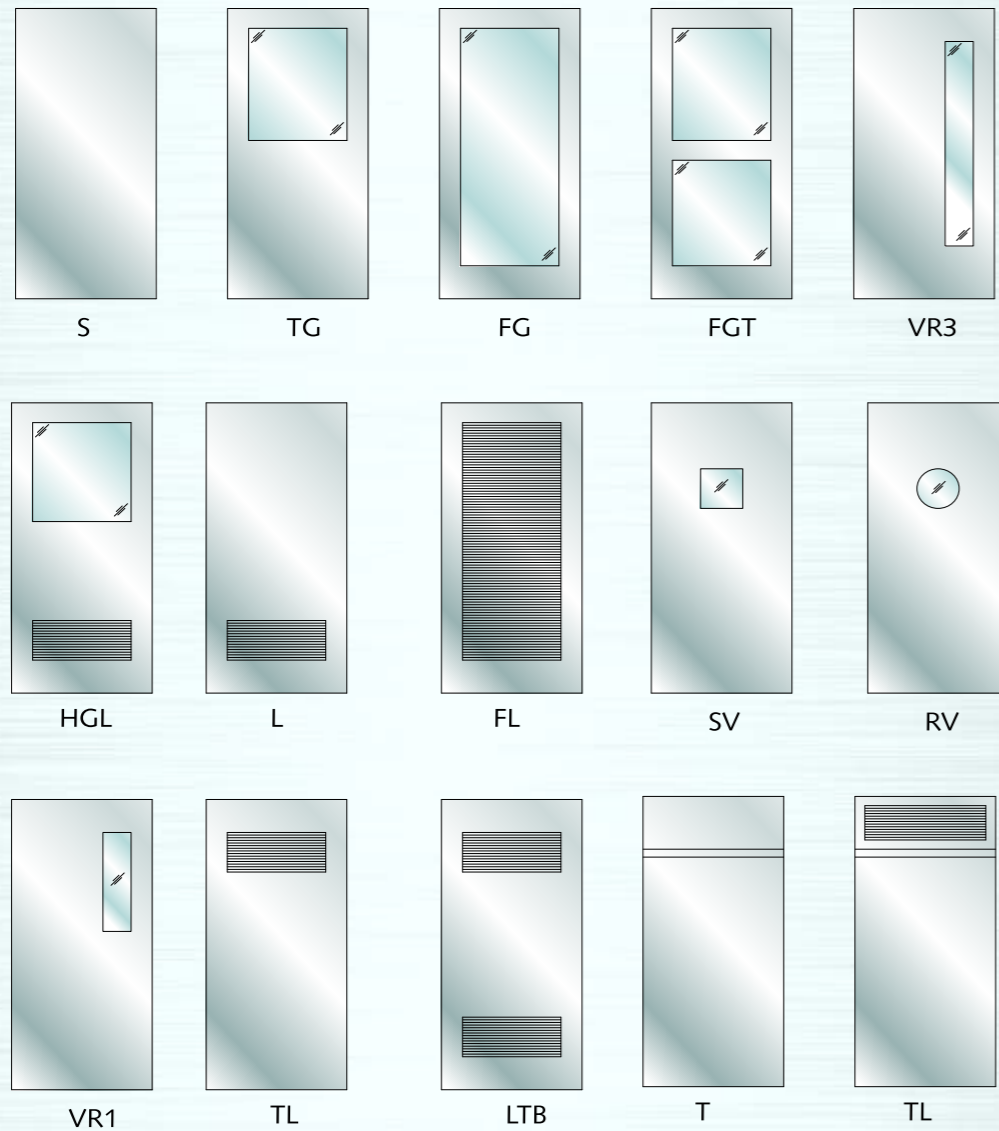

S- Solid
 TG – Top Glaze
 FG – Full Glaze
 FGT – Full glaze with transom
 SV – Square vision (300mm x 300mm)
 RV – Round Vision (300mm Dia)
 VR1 – Vision Rectangle (450mm X 200mm)
 VR3 – Vision Rectangle

HGL – Half glaze louver
 L – Louver
 FL – Full louver
 TL – Top Louver
 LTB – Louver Top and Bottom
 T – Transom
 TL – Transom with Louver

CORES

HONEYCOMB

- Superlative resistance to impact
- Smooth flat surface
- Extreme durability
- High Shear strength
- Prevent decay and pest destruction
- Versatility: permits modification

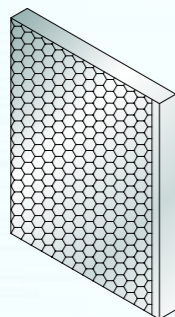

REINFORCEMENT

STEEL STIFFENER

- Void areas between the stiffeners are filled with Glass Wool or Mineral Wool
- Sound Retarding

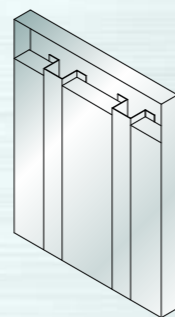

GMP fire door available in fire resistant levels from 30 minutes up to 2 hours all tested to BS 476 Part 22. These doorsets can be made in very large sizes with options for glazing, fire resistant self closing louvers, single or double doorsets, optional fixed overpanels and optional temperature rise (insulation) configurations.

Technical Specification

DOOR LEAF : (GPSP) ASTM A 527/ ASTM A525, JIS G 3302 or BS 2989 (1194). Zinc Coating 120-180g/m². Lock formed, 4mm thick hinge, reinforcing plates, hardware mounting plates and lock reinforcement.

DOOR FRAME : GPSP sheet with welded or knockdown constructions with 4mm hinge reinforcing plates, fixing straps, hardware mounting plates and mortar guards.

CORE MATERIAL : Non-combustible mineral fibre infill

FINISH : Powder coated



CERTIFICATION

Testing a FIRE DOOR as a complete assembly is the only way to prove that it is going to fulfill its rating and defined purpose. That is the basis of certification. GMP Doors are currently tested to BS 476 part 22 or EN1634, which require the test to be undertaken as a complete assembly including door leaf, frame, ironmongery and glazing. A rating is then given to the door assembly based on the time it has held back the fire without being breached. GMP has achieved a 120 min fire rating of its integrity (test no. 167954) of its doors under the stringent tests held by Warrington fire global safety.



Door Frame Construction

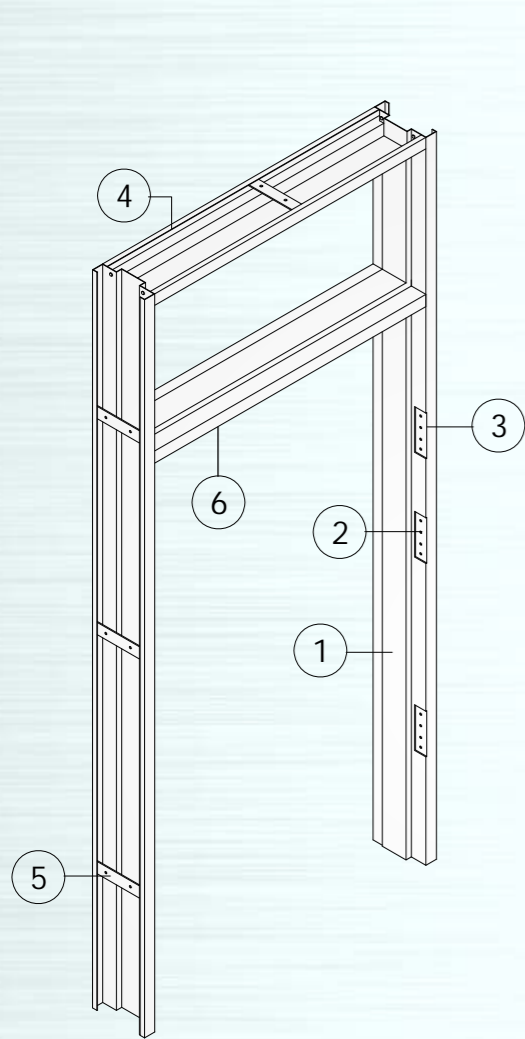

DOOR FRAME

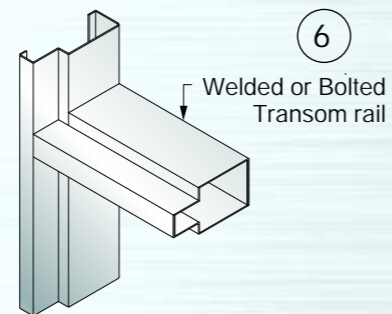
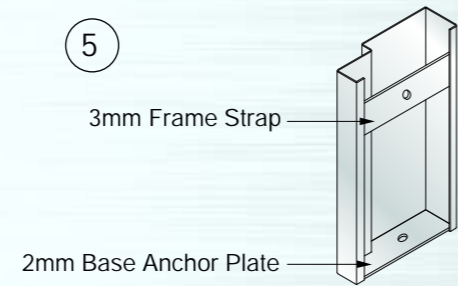
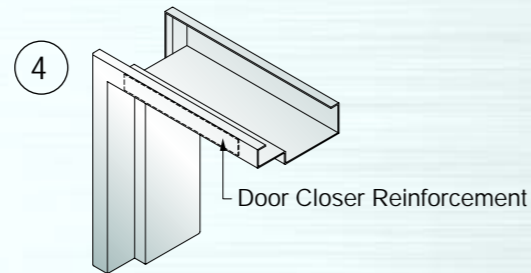
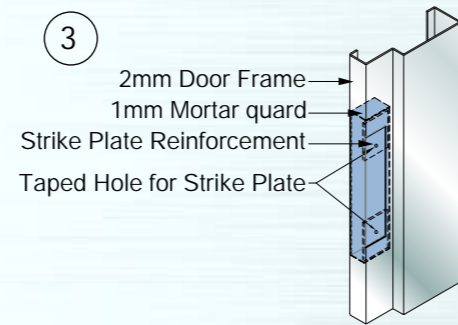
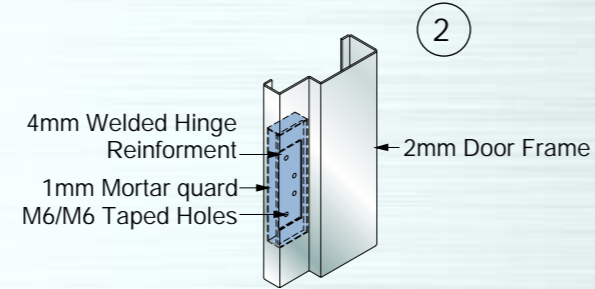
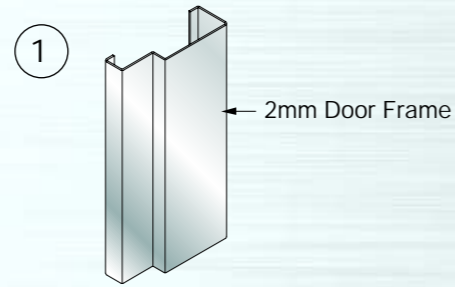
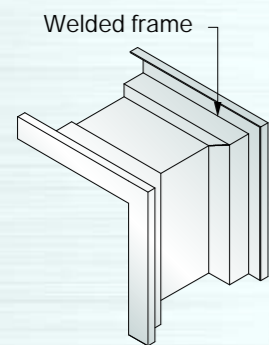
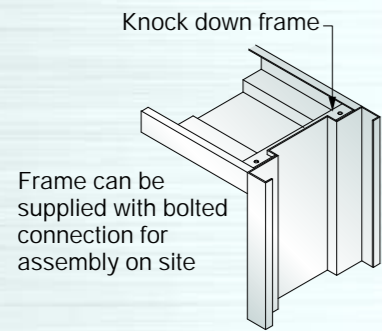

Door Leaf Construction

